

TERMINATION STYLE - 2 ROW PLUG CONTACTS

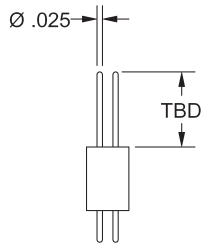

RAE
STACKING
Termination Length
is Application Specific

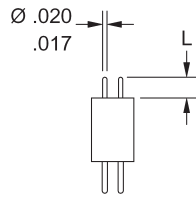

RBE
FLEX CABLE
'L'
1 = .050
2 = .098

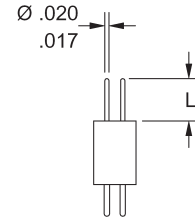

RDE
DIP SOLDER STRAIGHT
'L'
1 = .109
2 = .140
3 = .172
4 = .234
9 = User Defined

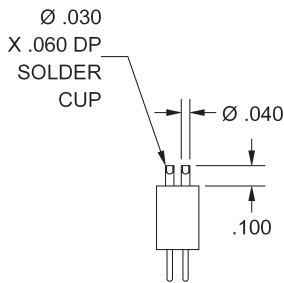

RSE0
SOLDER CUP

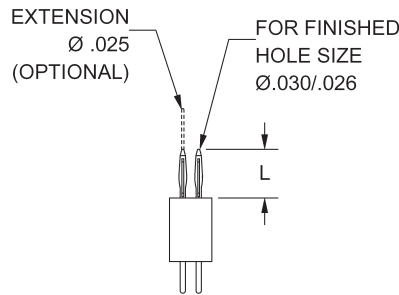

RVE
COMPLIANT
'L'
0 = Std .230
A = User Defined
Extension
(Compliant Stacking)

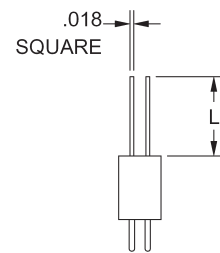

RWE
WIRE WRAP
'L'
1 = .375
2 = .500
3 = .625

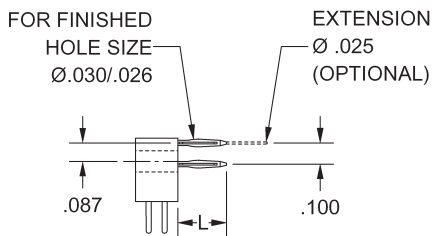

MLE
RIGHT ANGLE COMPLIANT
'L'
0 = Std .230
A = User Defined
Extension
(Compliant Stacking)

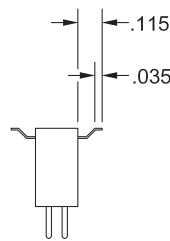

MRE9
SURFACE MOUNT

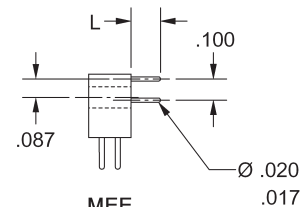

MEE
DIP SOLDER RIGHT ANGLE
'L'
1 = .109
2 = .140
3 = .172
4 = .234
9 = User Defined