

TERMINATION STYLES
RECEPTACLE (.315" INSULATOR), 6 ROW
HARDWARE OMITTED FOR CLARITY

FAE9
 STACKING

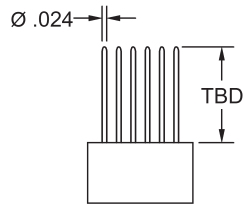

FVEA
 COMPLIANT
 STACKING

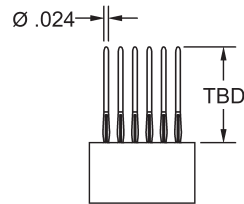

FBE
 FLEX CABLE

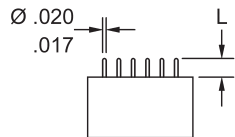

FDE
 DIP SOLDER
 STRAIGHT

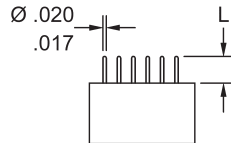

FEE
 DIP SOLDER
 RIGHT ANGLE

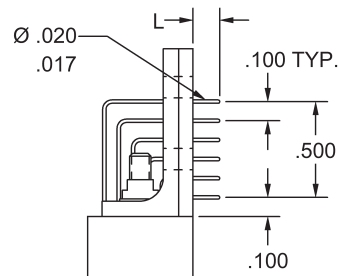

FSE
 SOLDER CUP

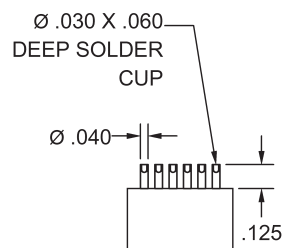

FVE
 COMPLIANT

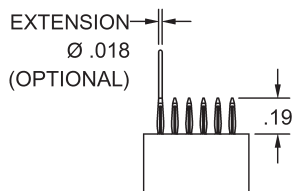

FWE
 WIRE WRAP

