

5900 SERIES SOCKET- ACCEPTS Ø1.50 mm (0.059) MATING PIN

DIP SOLDER

HSD5901-1

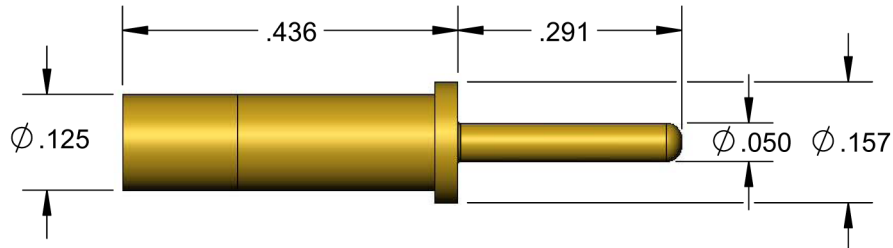

CRIMP

HSC5900-1

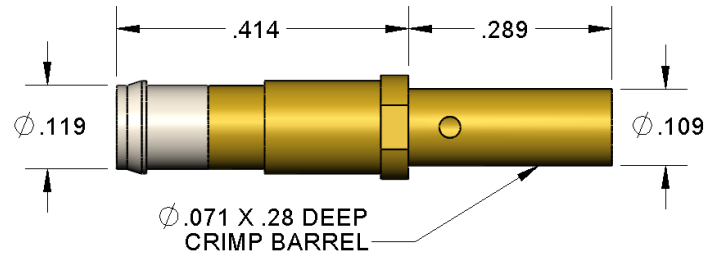

Accepts 14-20 AWG Wire

SOLDER CUP

HSS5900-1

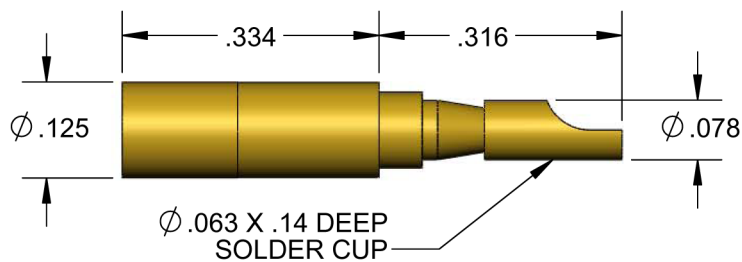

Accepts up to 16 AWG Wire

PWB

PART NO.	"L"
HSR5900-1	.28
HSR5900-2	.36

Note: Tin-Lead Plated

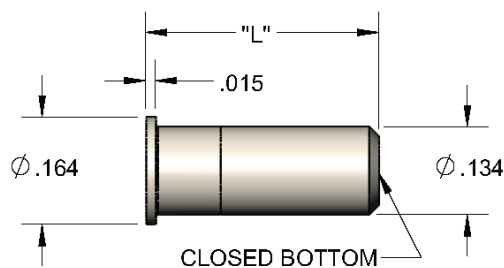

OTHER TERMINATION
STYLES AVAILABLE.
CONTACT FACTORY FOR
AVAILABILITY.